

# Mounting Instruction

## Product Parameters

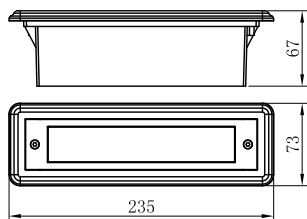

1. Model: 3861+B
2. Rated Voltage: AC 100-240V
3. Rated Power: LED 5W
4. IP Grade: IP65
5. Insulation protection level: Class I
6. Operating Temperature:  $-30\sim+45^{\circ}\text{C}$

## Components and Tools

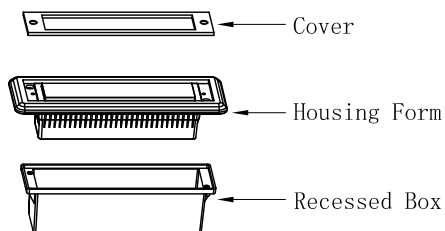

Recessed Box

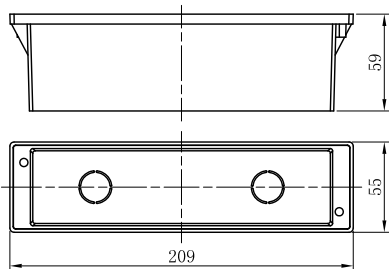

Mounting holes

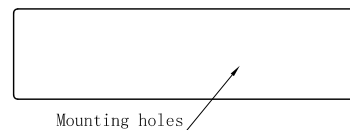

## Installation Steps

A

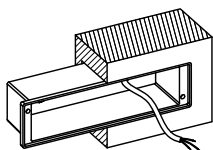

OFF

▲ The recessed box must be fixed tightly.

B

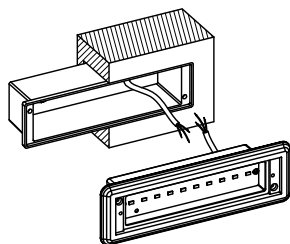

▲ Live line for L terminal, Null line for N terminal, Ground line for E terminal.

C

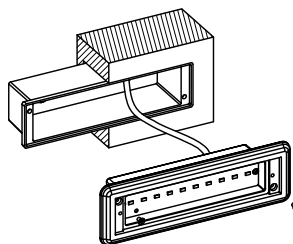

▲ Make sure the screws be fixed tightly.

D

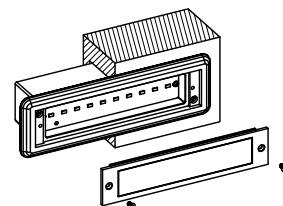

▲ Should be used diagonal way to lock screws by twice;  
①. At first, please lock the screws half;  
②. Secondly, lock the screws tightly.

E

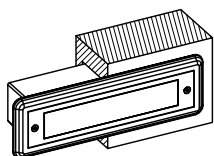

ON

▲ Connect the power supply, and light up the lamp.

F

G

H

## Attention

1. Lamp should be installed by professional electrician;
2. The light source contained in this luminaire shall only be replaced by the manufacturer or his service agent or a similar qualified person;
3. Check the power switch has been turned off;

4. Please read this user guide carefully before installation and keep for future reference;
5. If the external flexible cable or cord of this luminaire is damaged, it shall be exclusively replaced by the manufacturer or his service agent or a similar qualified person in order to avoid a hazard.